

Recommended mounting hole

DIMENSIONS ARE IN MILLIMETERS  
 UNLESS OTHERWISE SPECIFIED TOLERANCES  
 ANGLES =  $\pm 5'$   
 UP TO 6 =  $\pm 0.2$   
 6-40 =  $\pm 0.4$   
 40-120 =  $\pm 0.6$   
 120-315 =  $\pm 1$   
 ABOVE 315 =  $\pm 1.6$

**IO AUDIO TECHNOLOGIES**

TITLE  
**E Series 5P Male Chassis Connector**

THIRD\_ANGLE PART NO. **IO-XLR5-M-EV** REV. **A1**

SCALE **1.5/1**

NO.	DESCRIPTION	MATERIAL	FINISH	Q'TY
4	GROUND	H62	NICKEL	1
3	PIN	H59-1	GOLD	5
2	LOCK SLICE	65Mn	NICKEL	1
1	PLASTIC SHELL	PA	BLACK	1

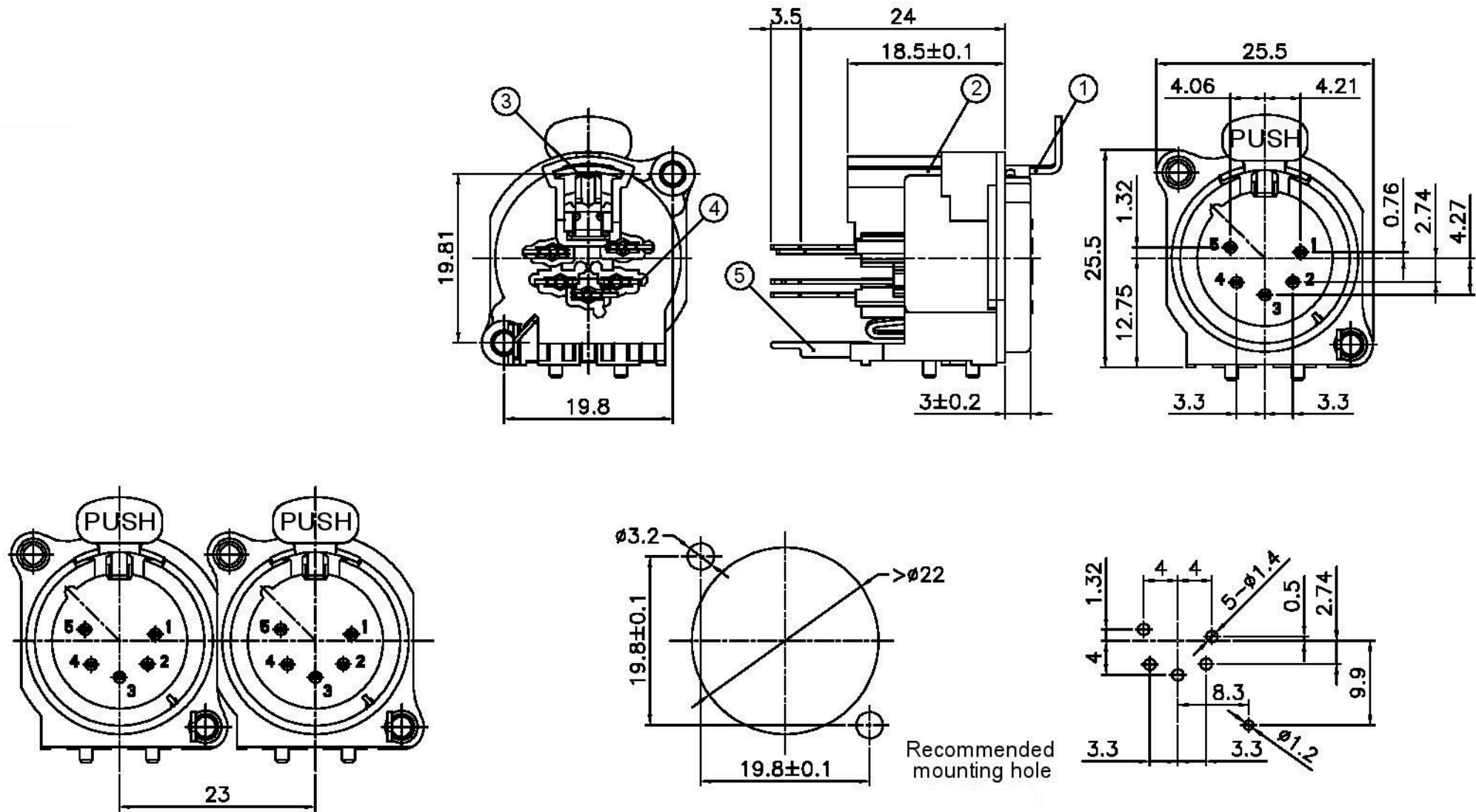

5	GROUND TERMINAL	H62	NICKEL	1
4	TERMINAL	H62	GOLD	5
3	LATCH	65Mn	NICKEL	1
2	BODY	PA	BLACK	1
1	PUSH BUTTON	H62	NICKEL	1
NO.	DESCRIPTION	MATERIAL	FINISH	Q'TY

DIMENSIONS ARE IN MILLIMETERS	
UNLESS OTHERWISE SPECIFIED TOLERANCES	
ANGLES	= ±5°
UP TO 6	= ±0.2
6-40	= ±0.4
40-120	= ±0.6
120-315	= ±1
ABOVE 315	= ±1.6
THIRD_ANGLE	
SCALE	1.5/1

<b>IO AUDIO</b> TECHNOLOGIES	
TITLE E Series 5P Female XLR Chassis Connector	
PART NO.	IO-XLR5-F-EV
REV.	A1