

NO.	DESCRIPTION	MATERIAL	FINISH	Q'TY
4	TERMINAL	H62	SILVER	1
3	PIN	H59-1	SILVER	5
2	INSULATOR	PA	BLACK	1
1	DIE CAST SHELL	ZZnAL4-0	Electro-coating black	1

DIMENSIONS ARE IN MILLIMETERS	
UNLESS OTHERWISE SPECIFIED TOLERANCES	
ANGLES = $\pm 5^\circ$	
UP TO 6 = $\pm 0.2$	
6-40 = $\pm 0.4$	
40-120 = $\pm 0.6$	
120-315 = $\pm 1$	
ABOVE 315 = $\pm 1.6$	
THIRD_ANGLE	
SCALE	1.5/1

# HAUDIO<sup>®</sup> TECHNOLOGIES

TITLE

## JL Series 5P Male XLR Chassis Connector

PART NO.	IO-XLR5-M-BK-JL	REV.	A1
----------	-----------------	------	----

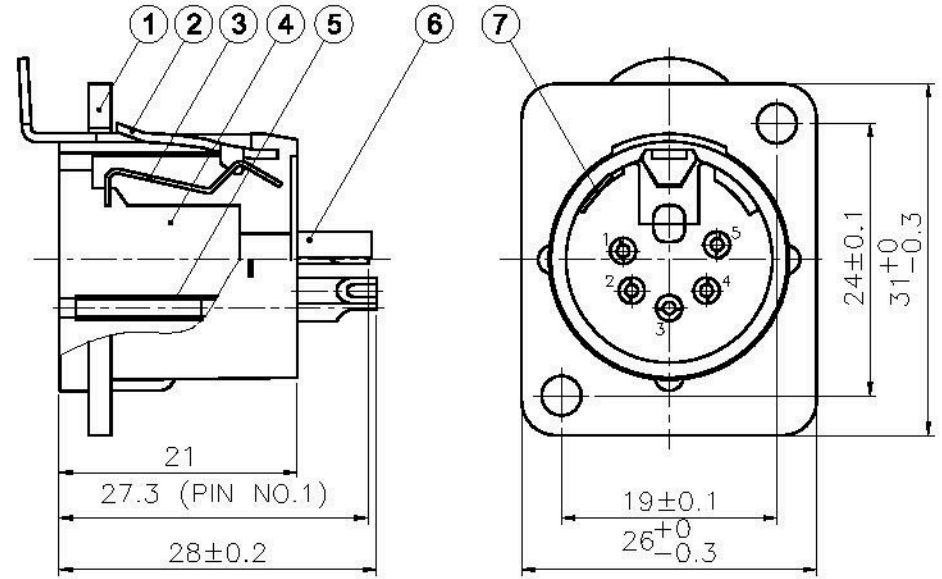
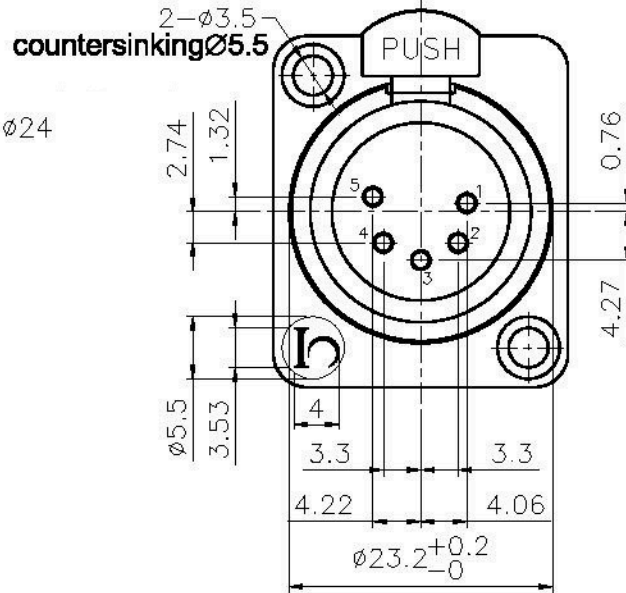
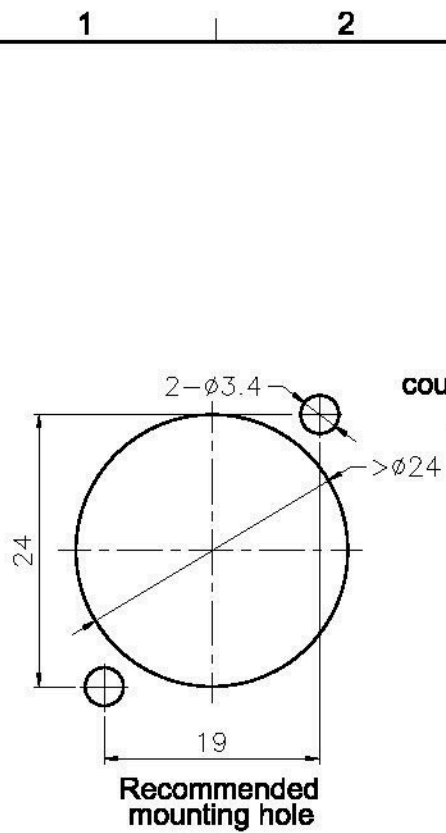

7	TERMINAL	H62	TIN	1
6	PIN	H59-1	SILVER	5
5	FEMALE PIN	PHOSPHOR BRONZE	SILVER	5
4	INSULATOR	PA	BLACK	1
3	LATCH	65Mn	Electro-coating black	1
2	PUSH BUTTON	H62	NICKEL	1
1	DIE-ZINC SHELL	ZZnA4-0	Electro-coating black	1
NO.	DESCRIPTION	MATERIAL	FINISH	Q'TY

DIMENSIONS ARE IN MILLIMETERS	
UNLESS OTHERWISE SPECIFIED TOLERANCES	
ANGLES = ±5°	
UP TO 6 = ±0.2	
6-40 = ±0.4	
40-120 = ±0.6	
120-315 = ±1	
ABOVE 315 = ±1.6	
THIRD_ANGLE	
SCALE	1/1

<b>JL Series 5P Female XLR Chassis Connector</b>	
<b>IO-XLR5-F-BK-JL</b>	
PART NO.	REV. A1

F  
E  
D  
C  
B  
A

F  
E  
D  
C  
B  
A

1 2 3 4 5 6 7 8

1 2 3 4 5 6 7 8