

**Recommended PCB Footprint
Mounting Holes – Component Side**

9	Ground Terminal	H62	Nickel	1
8	Latch Release	H62	Nickel	1
7	Pin 4	H62	Gold	1
6	Pin 3	H62	Gold	1
5	Pin 2	H62	Gold	1
4	Pin 1	H62	Gold	1
3	Face	PA (94 V-0)	Black	1
2	Body Shell	PA (94 V-0)	Black	1
1	Latch Catch	65Mn	Nickel	1
NO.	DESCRIPTION	MATERIAL	FINISH	Q'TY

DIMENSIONS ARE IN MILLIMETERS	
UNLESS OTHERWISE SPECIFIED TOLERANCES	
ANGLES = ±5°	
UP TO 6 = ±0.2	
6-40 = ±0.4	
40-120 = ±0.6	
120-315 = ±1	
ABOVE 315 = ±1.6	
THIRD_ANGLE	
SCALE	1/1

APPROVED	DATE
CHECKED	DATE
DRAWN	DATE
FILE NO.	
ERP LINK:	

Io Audio Technologies			
DESCRIPTION			
E Series 4 Pin XLR Female Chassis Connector, Horizontal PCB			
PART NO.	IO-XLR4-F-EH	REV.	A1

A

A

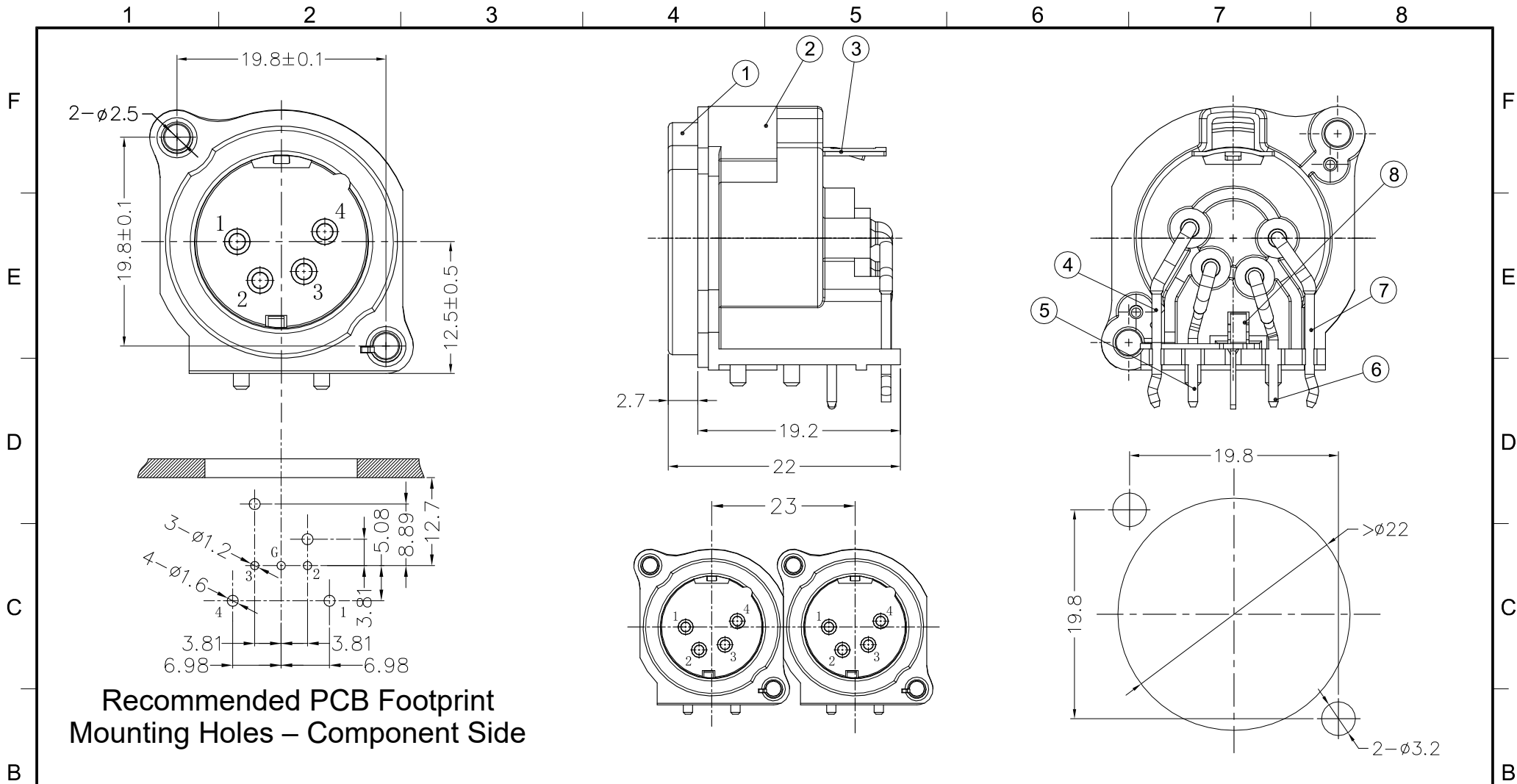

**Recommended PCB Footprint
Mounting Holes – Component Side**

8	Ground Terminal	H62	Nickel	1
7	Pin 1	H59-1	Gold	1
6	Pin 2	H59-1	Gold	1
5	Pin 3	H59-1	Gold	1
4	Pin 4	H59-1	Gold	1
3	Latch Catch	65Mn	Nickel	1
2	Body Shell	PA (94 V-0)	Black	1
1	Face	PA (94 V-0)	Black	1
NO.	DESCRIPTION	MATERIAL	FINISH	Q'TY

DIMENSIONS ARE IN MILLIMETERS		APPROVED	DATE
UNLESS OTHERWISE SPECIFIED TOLERANCES		CHECKED	DATE
ANGLES = ±5°		DRAWN	DATE
UP TO 6 = ±0.2			
6-40 = ±0.4			
40-120 = ±0.6			
120-315 = ±1			
ABOVE 315 = ±1.6			
THIRD_ANGLE			
SCALE	1/1		

Io Audio Technologies

DESCRIPTION
E Series 4 Pin XLR Male Chassis Connector,
Horizontal PCB

PART NO. **IO-XLR4-M-EH** REV. **A1**